

SCHAEFER

510

GT

[www.SchaeferYachts.ca](http://www.SchaeferYachts.ca)



***YACHT***  
SOLUTIONS

416.907.9046

[www.YachtSolutions.ca](http://www.YachtSolutions.ca)  
[info@theyachtsolution.com](mailto:info@theyachtsolution.com)

 @yacht\_solutions

 YACHT Solutions

 @theyachtsolution

 YACHT Solutions

# SCHAEFER

# 510

## GT

# YACHT

## SOLUTIONS

MODEL YEAR **2026**



**STANDARD PROPULSION**  
Twin Volvo Penta® IPS 700 D8



**FUEL CAPACITY**  
1300 L (343 gal)



**LENGTH OVERALL**  
51' 11" / 15.82 m  
with integral swim platform



**BEAM**  
14' 4" / 4.37 m



**DRAFT**  
4' 1" / 1.25 m



**DRY WEIGHT**  
40,344 lbs / 18,300 kg



**DEADRISE**  
17°



**WATER CAPACITY**  
470 L / 124 gal



**HOLDING TANK**  
100 L / 26.4 gal



**PASSENGER CAPACITY (DAY)**  
16



**PASSENGER CAPACITY (NIGHT)**  
7

### KEY FEATURES

- Luxurious Pininfarina Upgrade Available on this Model (shown above)
- Advanced helm station with Volvo Penta All-In-One Glass Cockpit System – Links effortlessly with your smartphone or tablet via Built-In WiFi
- Customizable salon and deck layouts make this yacht easy to personalize for your lifestyle or business needs.
- A free-flowing cockpit that includes a transom galley and fold-out starboard balcony provides plenty of space to entertain up to 16 guests and sleeps 7.
- Premium Fusion® audio system with Bluetooth®, Wi-Fi audio streaming with Apple AirPlay® 2 & Digital Signal Processing (DSP).



*pininfarina*

Specifications are approximations and subject to variance.

## STANDARD EQUIPMENT

### COCKPIT

- Hydraulic balcony on starboard
- Sofa upholstered in nautical courvin
- Silestone table
- Loudspeakers
- Teak floor
- LED courtesy lights
- Recessed LED ceiling light

### HELM STATION

- Stainless steel and leather marine steering wheel
- Dashboard in leather
- Captain's seat in leather
- Engine control display
- Bilge pump, exhaust controls switches
- Control of winch and wipers
- USB Outlets
- Horn
- Compass

### SALON

- LED Smart TV
- Soundbar
- Wooden Table
- Sofa
- Air conditioning
- Luxury Vinyl Flooring
- Electric windows

### GALLEY

- Countertop in Silestone® with sink and faucet
- Oven with Microwave
- 2 x Refrigerator
- 2 burner electric cooktop
- Furniture with drawers and holder for cups and plates
- 110V outlets

### MOORING

- 6 x Stainless steel cleats
- 1500W windlass with local and remote control
- 44lbs SS-Anchor and swivel and 196' galvanized chain

### STERN

- Gourmet station with sink and faucet
- Electric grill
- 2 x Ice boxes
- Stainless steel swim ladder with hand grip
- Aft shower with hot and cold water
- Platform in teak
- Battery charger + cable + shorepower inlet

### BOW

- Sun pad cushion with flip-up lounge seating
- Stainless Steel Rail
- Anchor locker, ropes and fender storage
- Winch control

### FLYBRIDGE

- Second helm station
- Wet bar with ice box
- Sofa upholstered in nautical courvin
- Stairs with steps in teak
- Silestone table
- Bimini
- 2 x Speakers

### MASTER CABIN

- 32" LED Smart TV
- Lacquered furniture with shelves and drawers
- Sofa
- Double Bed
- 2 x Bedside tables with reading lights
- Air conditioning in cabin and head
- Port holes for ventilation
- Carpet
- 110V Outlets
- 12V Courtesy lights
- Electric Toilet
- Separate shower with glass enclosure
- Vessel sink and faucet
- Mirror with storage

### CREW CABIN

- Single bed
- Electric Toilet
- Air conditioning
- 110 V Outlets

### LIGHTING

- Dimmable 12V LED Lights

### VIP CABIN

- Double Bed
- Lacquered furniture with shelves and drawers
- Air conditioning
- Carpet
- 110V Outlets
- 12V Courtesy lights
- Electric Toilet
- Shower with circular glass enclosure
- Vessel sink and faucet
- Mirror with storage

### STARBOARD CABIN (depending on floorplan)

- Twin bed with filler cushion for double bed
- Lacquered furniture with shelves and drawers
- Air conditioning
- Carpet
- 110V Outlets
- 12V Courtesy lights
- Electric Toilet
- Shower with circular glass enclosure
- Vessel sink and faucet
- Mirror with storage

## ENGINE ROOM

### BILGE PUMPS

- 1 x 3700GPH 12v bilge pumps, auto and manual switch
- 2 x 2000GPH 12v bilge pumps with auto and manual
- Flood alarm system

### AIR CONDITIONING SYSTEM

- Air conditioning controls in salon and cabins
- Salon with 24,000 BTU
- Master suite with 10,000 BTU
- VIP Suite with 10,000 BTU

### FRESH WATER SYSTEM

- Fresh water tank with 500 L (132 Gal) capacity

### OTHER EQUIPMENT

- 50 / 60A Galvanic Isolator
- Soundproofing
- Electric trim tabs
- Hot water system
- Full canvas enclosure (cockpit and flybridge)
- Window covers (snap in)
- FIREBOY Automatic fire suppression system

## LAYOUTS

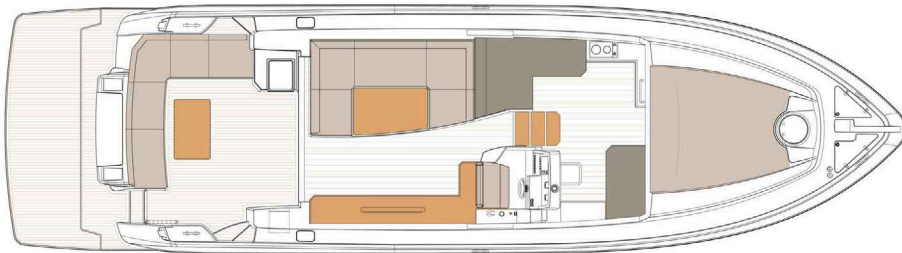

MAIN DECK - OPTION 1

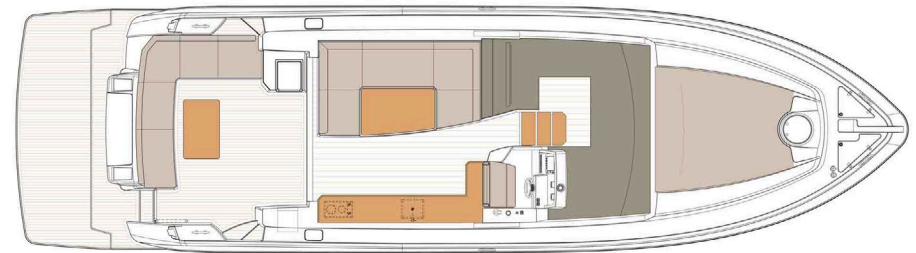

MAIN DECK - OPTION 2

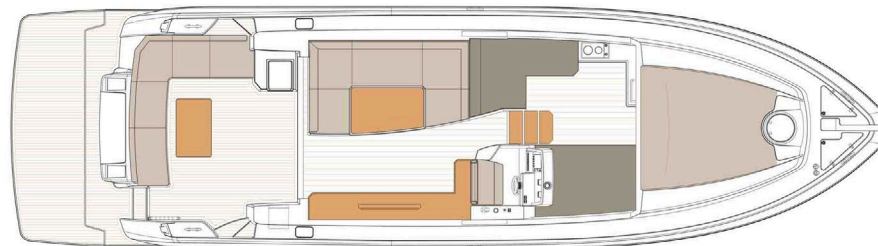

MAIN DECK - OPTION 3

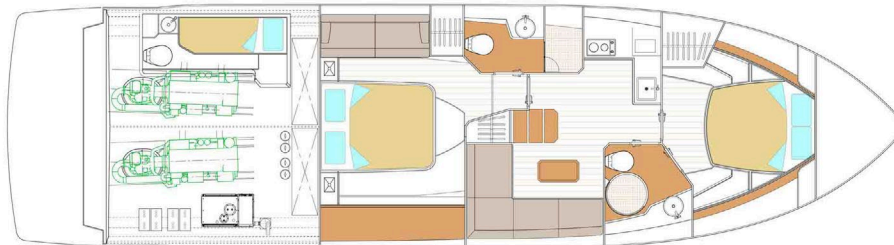

LOWER DECK - OPTION 1

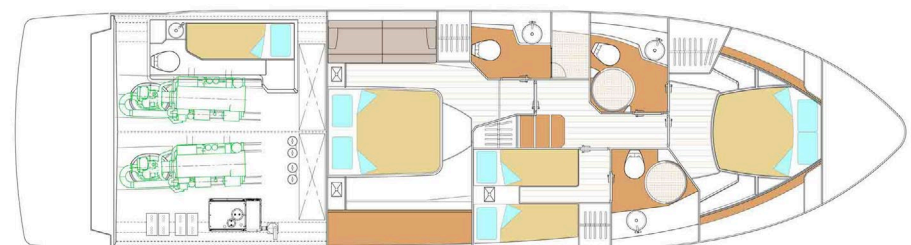

LOWER DECK - OPTION 2

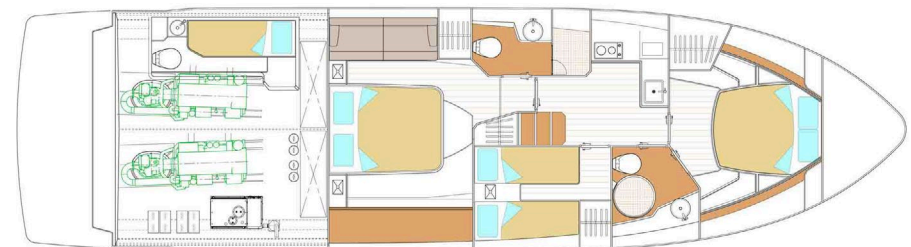

LOWER DECK - OPTION 3

## CONSTRUCTION

- Vacuum infused hull
- GRP with PVC foam coated hull, deck and superstructure
- Structural chassi with girder and floor plate
- Isophtalic gelcoat
- Estervynil resin skin coat
- All deck hardware produced in 316L stainless steel
- Certified tinned wires

*Specifications are approximations and subject to variance.*

Introducing the new Schaefer 510 GT. What was already an amazing yacht just got better. Featuring a full-beam midship suite with over six feet in headroom provides the space and comfort you'd expect from a thoroughbred. With a comfortable midship master suite, 3 internal layout options for up to 3 suites, a large aft square and gourmet space on the platform, the Schaefer 510 GT redefines the concept of space in a 50-foot yacht.



YACHT Solutions | 416.907.9046 | [yachtsolutions.ca](http://yachtsolutions.ca)

**Note:** Not all accessories shown in pictures or described herein are standard equipment or even available as options. Some features and options may not be available when a boat is built. Options and features are subject to change without notice. Not all model year boats may contain all the features or meet the specifications described herein. Confirm availability of all accessories and equipment prior to purchase.



YACHT Solutions | 416.907.9046 | [yachtsolutions.ca](http://yachtsolutions.ca)

**Note:** Not all accessories shown in pictures or described herein are standard equipment or even available as options. Some features and options may not be available when a boat is built. Options and features are subject to change without notice. Not all model year boats may contain all the features or meet the specifications described herein. Confirm availability of all accessories and equipment prior to purchase.



YACHT Solutions | 416.907.9046 | [yachtsolutions.ca](http://yachtsolutions.ca)

**Note:** Not all accessories shown in pictures or described herein are standard equipment or even available as options. Some features and options may not be available when a boat is built. Options and features are subject to change without notice. Not all model year boats may contain all the features or meet the specifications described herein. Confirm availability of all accessories and equipment prior to purchase.



YACHT Solutions | 416.907.9046 | [yachtsolutions.ca](http://yachtsolutions.ca)

**Note:** Not all accessories shown in pictures or described herein are standard equipment or even available as options. Some features and options may not be available when a boat is built. Options and features are subject to change without notice. Not all model year boats may contain all the features or meet the specifications described herein. Confirm availability of all accessories and equipment prior to purchase.



YACHT Solutions | 416.907.9046 | [yachtsolutions.ca](http://yachtsolutions.ca)

**Note:** Not all accessories shown in pictures or described herein are standard equipment or even available as options. Some features and options may not be available when a boat is built. Options and features are subject to change without notice. Not all model year boats may contain all the features or meet the specifications described herein. Confirm availability of all accessories and equipment prior to purchase.

Creating more than 600 direct jobs in Brazil with a vertically integrated production process, Schaefer Yachts guarantees a timely delivery of your boat while attaining the highest quality standards.

With one of the biggest machining equipment of the Americas, Schaefer Yachts CNC guarantees the accuracy in the production of all parts involved in the project.

All parts are produced by a vacuum infusion process resulting in lightweight and sturdy vessels that provide a more comfortable, safe and economical journey.

With its own in-house woodwork, Schaefer Yachts found the solution to bring the finish and refinement desired in our boats.



YACHT Solutions | 416.907.9046 | [yachtsolutions.ca](http://yachtsolutions.ca)

**Note:** Not all accessories shown in pictures or described herein are standard equipment or even available as options. Some features and options may not be available when a boat is built. Options and features are subject to change without notice. Not all model year boats may contain all the features or meet the specifications described herein. Confirm availability of all accessories and equipment prior to purchase.

## 5-AXIS CNC MACHINE

The new product development center is equipped with a 5-axis CNC, the only one in the Brazilian nautical market, it is able to machine molds up to 75 feet from a single block with the highest standards of quality, accuracy, and finish. A unique construction process, one of the most modern in the world, places Schaefer Yachts in the lead of the production of recreational boats in South America.

## VACUUM INFUSION PROCESS

All parts of each vessel from 36 to 83 feet are produced by vacuum infusion system, resulting in lighter more economical and robust vessels, providing more comfort and safety for its navigation.



YACHT Solutions | 416.907.9046 | [yachtsolutions.ca](http://yachtsolutions.ca)

**Note:** Not all accessories shown in pictures or described herein are standard equipment or even available as options. Some features and options may not be available when a boat is built. Options and features are subject to change without notice. Not all model year boats may contain all the features or meet the specifications described herein. Confirm availability of all accessories and equipment prior to purchase.